

**vtech**<sup>®</sup>

# Instruction Manual

## Smart Medical Kit



**VTech understands that a child's needs and abilities change as they grow and with that in mind we develop our toys to teach and entertain at just the right level...**

## Electronic Learning Computers

**Cool, aspirational and inspiring computers for curriculum related learning**

### **vtech** Baby

**Toys that will stimulate their interest in different textures, sounds and colours**

#### **I am...**

...responding to colours, sounds and textures

...understanding cause and effect

...learning to touch, reach, grasp, sit-up, crawl and toddle

Birth-36 months



### **Pre-School**

**Interactive toys to develop their imagination and encourage language development**

#### **I want...**

...to get ready for school by starting to learn the alphabet and counting

...my learning to be as fun, easy and exciting as can be

...to show my creativity with drawing and music so my whole brain develops

3-6 years



4-10 years



To learn more about this and other VTech® products, visit [www.vtech.co.uk](http://www.vtech.co.uk)

# INTRODUCTION

Thank you for purchasing the **Smart Medical Kit!**

This medical playset includes 16 play pieces for interactive play.

Put on the dress-up doctor's costume, pick up the interactive healthcare tablet and let's play!

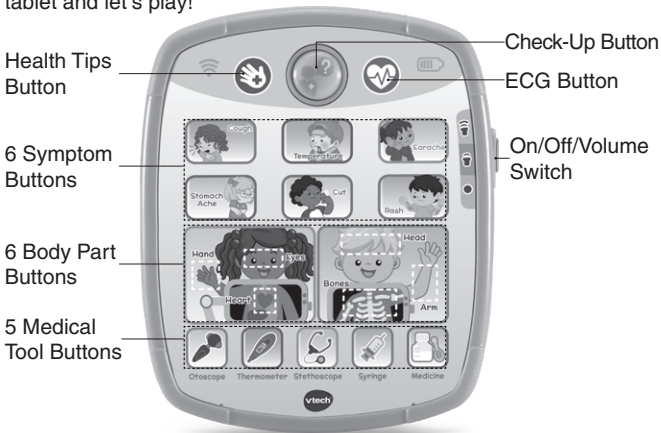

## INCLUDED IN THE PACKAGE

- **Smart Medical Kit**
- **Quick Start Guide**



• Doctor's Costume



• Medical Bag



• Stethoscope



• Otoscope



• Syringe



• Thermometer



• Tweezers



• Mirror



• Scissors



• Pager



• Medicine Bottle



• 2 Spoons



• Doctor's ID Card



• Medicine Cup



• Healthcare Tablet

## WARNING:

All packing materials such as tape, plastic sheets, packaging locks, removable tags, cable ties, cords and packaging screws are not part of this toy and should be discarded for your child's safety.

## NOTE:

Please save this Instruction Manual it contains important information.

### Unlock the packaging locks:

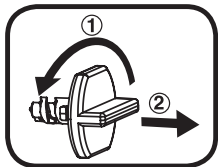

- ① Rotate the packaging locks 90 degrees anticlockwise.
- ② Pull out the packaging locks.

# INSTRUCTIONS

## BATTERY REMOVAL AND INSTALLATION

1. Make sure the unit is turned **OFF**.
2. Locate the battery cover on the back of the unit. Use a screwdriver to loosen the screw and then open the battery cover.
3. If used batteries are present, remove these batteries from the unit by pulling up on one end of each battery.
4. Install 2 new AA batteries following the diagram inside the battery box. (For best performance, alkaline batteries or fully charged Ni-MH rechargeable batteries are recommended.)
5. Replace the battery cover and tighten the screw to secure.

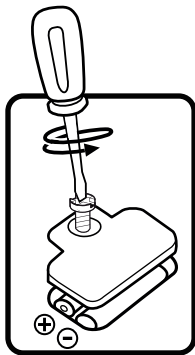

## WARNING:

Adult assembly required for battery installation.  
Keep batteries out of reach of children.

## **IMPORTANT: BATTERY INFORMATION**

- Insert batteries with the correct polarity (+ and -).
- Do not mix old and new batteries.
- Do not mix alkaline, standard (carbon-zinc) or rechargeable batteries.
- Only batteries of the same or equivalent type as recommended are to be used.
- Do not short-circuit the supply terminals.
- Remove batteries during long periods of non-use.
- Remove exhausted batteries from the toy.
- Dispose of batteries safely. Do not dispose of batteries in fire.

### **RECHARGEABLE BATTERIES:**

- Remove rechargeable batteries from the toy before charging.
- Rechargeable batteries are only to be charged under adult supervision.
- Do not charge non-rechargeable batteries.

## Disposal of batteries and product



The crossed-out wheellie bin symbols on products and batteries, or on their respective packaging, indicates they must not be disposed of in domestic waste as they contain substances that can be damaging to the environment and human health.

The chemical symbols Hg, Cd or Pb, where marked, indicate that the battery contains more than the specified value of mercury (Hg), cadmium (Cd) or lead (Pb) set out in the Batteries and Accumulators Regulation.



The solid bar indicates that the product was placed on the market after 13th August, 2005.

Help protect the environment by disposing of your product or batteries responsibly.

### **VTech® cares for the planet.**

Care for the environment and give your toy a second life by disposing of it at a small electricals collection point so all its materials can be recycled.

#### **In the UK:**

Visit [www.recyclenow.com](http://www.recyclenow.com) to see a list of collection points near you.

#### **In Australia & New Zealand:**

Check with your local council for kerbside collections.

# LABEL APPLICATION

Optional labels are included for decorating play pieces. Please stick the labels to the medical tools securely as indicated below:

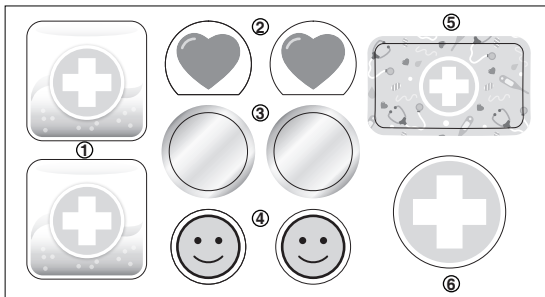

# DOCTOR'S ID CARD



Insert the Doctor's ID Card into the elastic strips on the Doctor's Costume.





# PRODUCT FEATURES

## 1. On/Off/Volume Switch

To turn the unit **On**, slide the **On/Off/Volume Switch** to the Low Volume  or the High Volume  position. To turn the unit **Off**, slide the **On/Off/Volume Switch** to the **Off**  position.



## 2. Check-Up and Symptom Buttons

Press the **Check-Up Button** to enter check-up mode, or one of the six **Symptom Buttons** to learn about common illnesses. The lights will flash with the sounds.



## 3. Touch Icons

Press the **Health Tip** or the **ECG Button** to hear health tips, fun songs and sounds. Touch the six **Body Part Buttons** to learn about different parts of the body or the five **Medical Tool Buttons** to hear about the doctor's medical instruments.



## 4. Accessories

Use the included accessories like the **Otoscope**, **Stethoscope**, **Syringe** or **Thermometer** for even more role play fun.



## 5. Automatic Shut-Off

To preserve battery life, the **Smart Medical Kit** will automatically power down after several seconds without input. The unit can be turned on again by pressing the **Check-Up Button** to enter quiz mode.

**NOTE:** If the unit powers down or if the light fades out during play, please install a new set of batteries.

## ACTIVITIES

### 1. Symptom Checker Mode

Press the six **Symptom Buttons** help children understand common illnesses.



### 2. Body Part Mode

Press the six different **Body Part Buttons** to learn about each body part and how to help your patient.

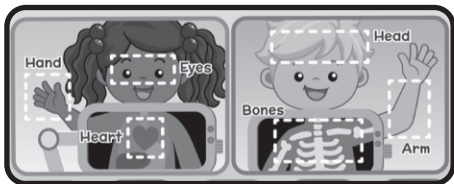

### 3. Learning Mode

Press the five **Medical Tool Buttons** to explore instruments doctors use and how they help people.



### 4. Quiz Mode



Answer questions about your patient to help diagnose their illness.

### 5. Health-Tips Mode



Touch to hear health-tips and health themed songs.

# SONGS

## Song 1

When it's time to wash your hands, sing this song!

Wet your hands and add soap, it won't take long

Rubby, scrubby, count to twenty!

Rinse the bubbles, there'll be plenty

Dry,dry, then you're done!

## Song 2

You can eat a rainbow, it's so easy!

Eat some fruit and veggies everyday,

A crunchy red apple, or a juicy orange,

Little green peas or some lettuce leaves.

Don't be afraid to try something new!

## Song 3

If you want to keep your body feeling great,

Move your body every day!

Go outside and throw a ball or go for a walk.

Let's all have some fun and a healthy snack.

## CARE & MAINTENANCE

1. Keep the unit clean by wiping it with a slightly damp cloth.
2. Keep the unit out of direct sunlight and away from any direct heat sources.
3. Remove the batteries if the unit will not be in use for an extended period of time.
4. Do not drop the unit on hard surfaces and do not expose the unit to moisture or water.
5. When the doctor's apron and doctor's bag are dirty, they can be hand-washed or gently machine-washed and hung up to air dry.

## TROUBLESHOOTING

If for some reason the unit stops working or malfunctions, please follow these steps:

1. Turn the unit **Off**.
2. Interrupt the power supply by removing the batteries.
3. Let the unit stand for a few minutes, then replace the batteries.
4. Turn the unit **On**. The unit should now be ready to use again.
5. If the unit still does not work, replace with a new set of batteries.

If the problem persists, please contact our Consumer Services Department and a service representative will be happy to help you.

# CONSUMER SERVICES

Creating and developing **VTech®** products is accompanied by a responsibility that we at **VTech®** take very seriously. We make every effort to ensure the accuracy of the information, which forms the value of our products. However, errors sometimes can occur. It is important for you to know that we stand behind our products and encourage you to call our Consumer Services Department with any problems and/or suggestions that you might have. A service representative will be happy to help you.

## **UK Customers:**

Phone: 0330 678 0149 (from UK) or +44 330 678 0149 (outside UK)

Website: [www.vtech.co.uk/support](http://www.vtech.co.uk/support)

## **Australian Customers:**

Phone: 1800 862 155

Website: [support.vtech.com.au](http://support.vtech.com.au)

## **NZ Customers:**

Phone: 0800 400 785

Website: [support.vtech.com.au](http://support.vtech.com.au)

# PRODUCT WARRANTY/ CONSUMER GUARANTEES

## **UK Customers:**

Read our complete warranty policy online at [vtech.co.uk/warranty](http://vtech.co.uk/warranty).

## **Australian Customers:**

VTECH ELECTRONICS (AUSTRALIA) PTY LIMITED –  
CONSUMER GUARANTEES

Under the Australian Consumer Law, a number of consumer guarantees apply to goods and services supplied by VTech Electronics (Australia) Pty Limited. Please refer to [vtech.com.au/consumerguarantees](http://vtech.com.au/consumerguarantees) for further information.

**Visit our website for more  
information about our products,  
downloads, resources and more.**

***www.vtech.co.uk***  
***www.vtech.com.au***

